

# AMANUMA Dormitory



## Point



- Convenient for shopping at nearby supermarket
- No transportation fee to school
- Quiet residential area

## Expenses



- Entrance fee ¥40,000
- Deposit ¥20,000 (1 year)
- Rent ¥22,000 & ¥25,000/m
- Utility fee Actual expenses (Approx. ¥6,000/m)



## Facilities

- <Common> Dining Kitchen, Shower Room, Lavatory, Wash Basin, Microwave, Refrigerator, Rice Cooker, Washing Machine, Vacuum Cleaner, Wi-Fi
- <Room> Air Conditioner, Desk and chair (or Table only), Futon bedding



- Capacity 6 people (6 people x 1 unit)
- Room for two x 3 rooms

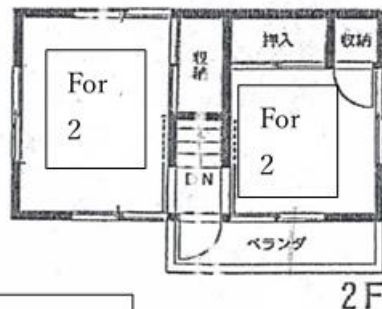

## Access

- To school : Approx. 10 min by bicycle
- Nearest station (JR Saitama Shintoshin Sta.): 8 min by bicycle
- 《From the station》

- To Shinjuku Approx. 35 min (One way ¥480)
- To Shibuya Approx. 40 min. (One way ¥480)
- To Akihabara Approx. 35 min (One way ¥480)



## Surrounding Environment

- Convenience store: 2 min on foot
- Supermarket: 5 min on foot
- Post Office: 3 min on foot
- Clinic: 4 min on foot



Room for two①



Room for two②



Room for two③



Kitchen



Dining Room



Laundry