

KAMIKIZAKI Dormitory



Point

- No transportation expense to school
- Refrigerator in each room
- Good access to supermarket and the station



Expenses

Initial Fee: ¥70,000
 Rent: ¥38,000~40,000/month
 Utility Fee: ¥8,000/m



Facilities

<Common> Dining Kitchen, Bathroom, Lavatory, Wash Basin, Microwave, Rice Cooker, Washing Machine, Vacuum Cleaner, Wi-Fi
 <Room> Bed, Bedding Set, Air Conditioner, Refrigerator, Desk and Chair(or a table only)



Capacity 6 people (3 people x 2 apartments / Single Room(6.98m²) x 2 rooms, Single Room(9.29m²) x 4 rooms)

Access

To School: 15 min by bicycle

Nearest station(JR Yono Sta.): 9min on foot

《From the station》

To Shinjuku: 40min (One way ¥480)

To Shibuya: 45min (One way ¥480)

To Akihabara: 40min (One way ¥480)



Surrounding Environment

Convenience Store: 1 min on foot

Supermarket: 4 min on foot

Hospital: 3 min on foot

Post Office: 4 min on foot

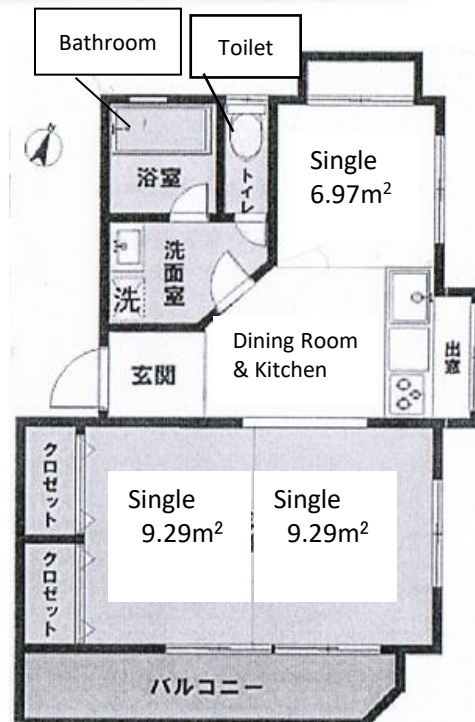

Private room①



Private room②



Private room③



Dining room



Laundry



Kitchen